

Planning Permit No. A/1156/92
APPROVED
 SUBJECT TO THE CONDITIONS IN THIS OFFICE LETTER.
 No. A/114526/92 D.C. 08/92
 FOR MEMBER SECRETARY
 MADRAS METROPOLITAN
 DEVELOPMENT AUTHORITY
 MADRAS - 600 008.

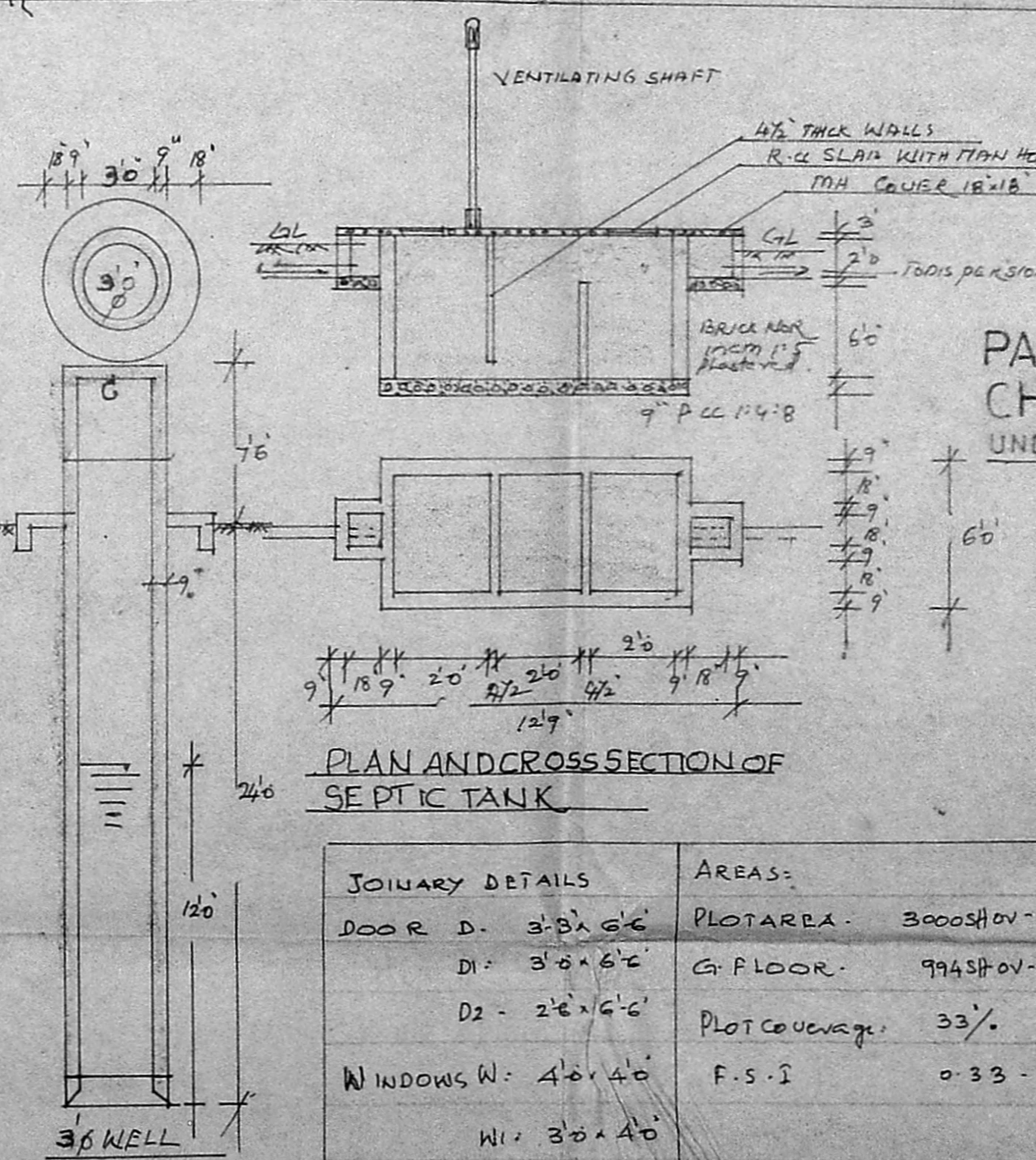

JOINARY DETAILS	AREAS:
DOOR D. 3'-8" x 6'-6"	PLOT AREA - 3000 SFT - 278.0 m ²
D1 - 3'-0" x 6'-2"	G. FLOOR - 994 SFT - 92.34 m ²
D2 - 2'-6" x 6'-6"	PLOT COVERAGE - 33%
WINDOWS W. 4'-0" x 4'-0"	F.S.I - 0.33
W1 - 3'-0" x 4'-0"	
VENTILATOR - V - 3'-0" x 2'-0"	
R.C. JALY - 3'-0" x 4'-0"	

PLAN SHOWING THE PROPOSED
 CONSTRUCTION OF A RESIDENCE
 IN PLOT No 121 Part
 MADIPPAKKAM VILLAGE
 IN S No 128/2 129/3
 PATTANo 128/2IA/2 SAIDAPET TALUK
 CHENGAI ANNA DISTRICT
 UNDER RECONSTITUTION scale 1/96

Planning
 M. N. Narasimhan
 A/E

G. VISWANATHAN NAIR
 LICENSED SURVEYOR
 CIVIL ENGINEERING CONTRACTOR
 5-A, SAYEE NAGAR
 MADRAS-92

SUBDIVISION OF PROPERTY OF G. VENKATESAN TO R. VENKATESAN AND M. N. NARASIMHAN AS PER DOC NO 883-1114 JULY 1991
 SUBDIVISION OF PLOT NO 121 AS ON 1963 SEPTEMBER 12¹⁵ REGD AS DOC NO 1971 OF 1963 AT SRO PALLAVARAM

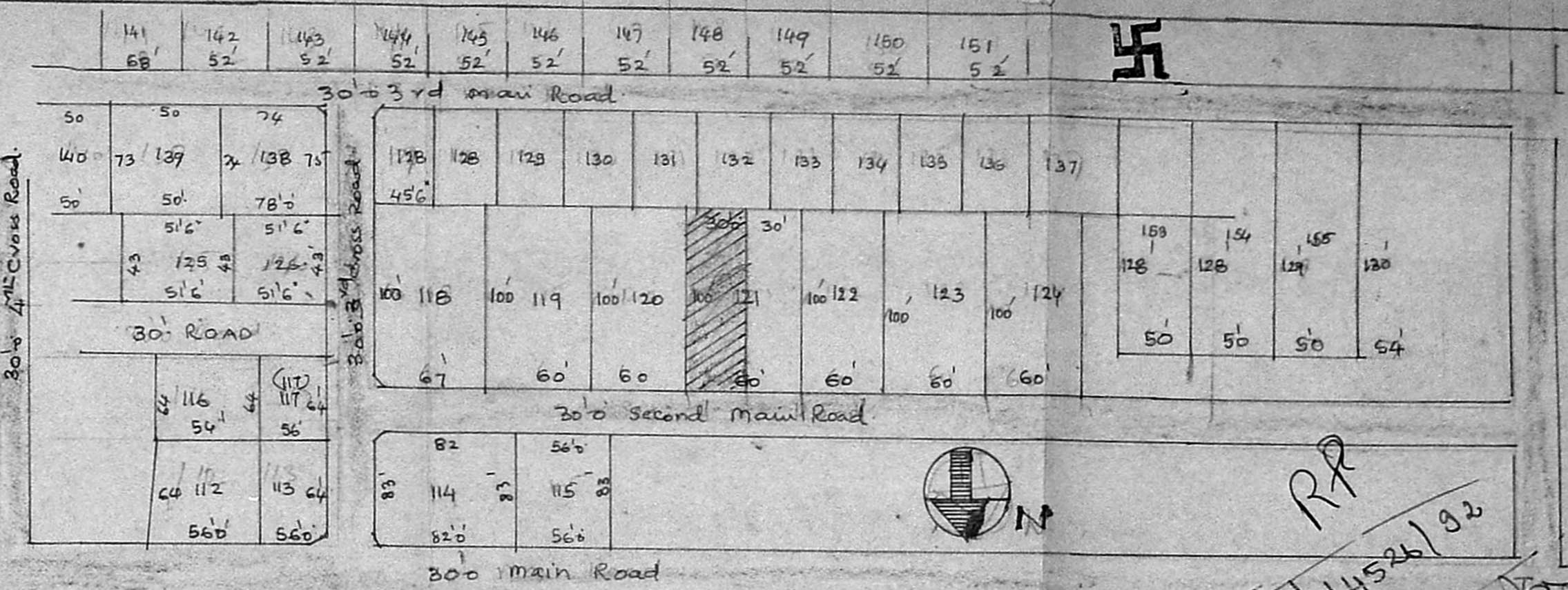

A/114526/92

MADIPPAKKAM ROAD